

A new padlock with a renewed design. High robustness with a contemporary design, including wireless online, RFID and BLE connectivity and a sophisticated warning LED. Special for gates, closets, cabinets, etc. Any door where it is impossible to install an escutcheon, cylinder or wall













reader. Installation without any wiring and without the need to make any kind of installation. Battery powered. Protected with a special cover which keeps the padlock completely secure against any weather conditions. Its IP68 makes it perfect for external doors and/or gates.

Experience a safer  
and more open world

**SMARTAIR®**  
Your Access. Your Control.

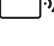

## Technical data - SMARTair padlock

	<b>Door profiles</b>	External gates, closets, cabinets, etc.
	<b>Traffic volume</b>	Medium to high
	<b>Exterior usage</b>	IP68 Certification. Resistant to real extreme weather conditions Up to 85% humidity -20°C to + 70°C
	<b>Hardware compatibility and installation</b>	High retrofit No drilling, no wiring
	<b>Power supply</b>	Battery (60.000 cycles) Depending on the reading technology (MIFARE, DESFire, Etc.) Max. 2 years standby (depending on cycles per day) Type of batteries: One CR2 3V Lithium battery
	<b>Multi-authentication</b>	No
	<b>Certifications</b>	CE (EMC, R&TTE) ROHS, REACH, WEE, Durability EN15684 Class 6, IP68
	<b>RFID technologies</b>	13,56MHz Read & Write technologies MIFARE Classic and Ultralight, HID iCLASS, DESFire, SKIDATA
	<b>Compatible mobile solutions</b>	 Openow™ (Bluetooth® Low Energy)   TESA SMARTair (only with WIRELESS system)
	<b>System management upgradability</b>	Compatible with all SMARTair systems: · Standalone* · Offline/Update on card* · Offline/Update on card + Openow · Wireless + Openow SMARTair padlocks can be: · Upgraded from Standalone -> Offline/Update on Card* · Upgraded from Offline/Update on Card + Openow -> Wireless + Openow Both options just changing the firmware with the programming device.

\*The padlock does not include the Openow or Wireless + Openow module. Therefore, it is not possible to upgrade them to Offline/Update on card + Openow or to Wireless + Openow.

# Electronic Technical Characteristics

The *i-gate* padlock includes all components: reader module, battery module and control unit. For wireless and mobile solutions, it will also include the necessary RF module.

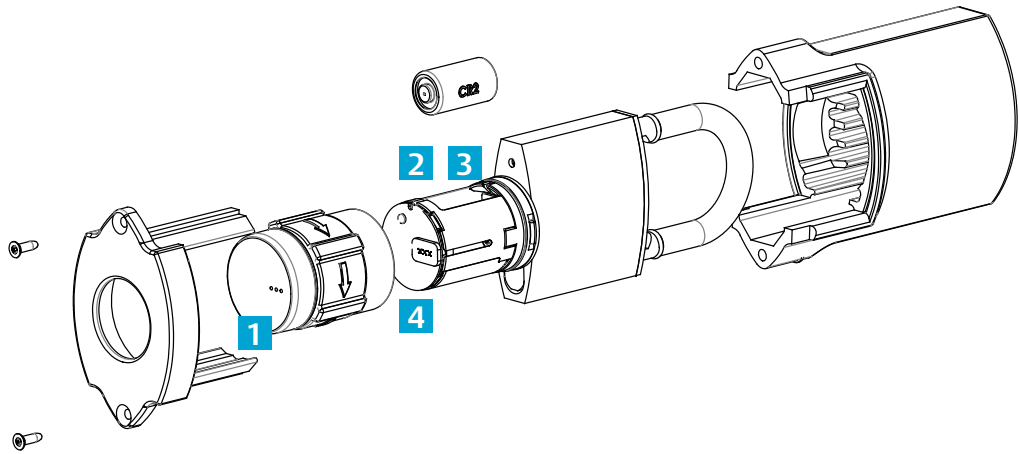

## 1 Reader Module

- 13,56MHz RFID Technology: just changing the firmware the *i-gate* padlock will work with one of the available reading technologies: MIFARE Classic (or Ultralight), HID iCLASS or DESFire
- Activation mode: the *i-gate* padlock will wake up just by approaching the credential, without the need to make any previous action
  - Reading distance: 1-2 cm. Given by the identification technology
  - Warning LED: blue or red lights for different warning actions: granted access, access denied, low battery level, etc
  - Connection to the programming device: through a special cable with three pins. Necessary to initialize the *i-gate* padlock and to make emergency openings (in case of low battery level)

## 2 Control unit and battery module

- Non-volatile memory
- Memory capacity: up to 3.000 users and the last 1.200 events
- Real time clock and calendar: up to 30 time zones with five different periods on each one. 365 days calendar. Weekdays and weekends are automatically recognized. Holidays defined in the calendar. The calendar requires updates once per year. Manually (offline or update on card) or automatically (wireless). DST's automatically updated
- Battery module: easy battery change. Maintains clock and calendar for 5 minutes without batteries. The battery status reported on every event or once per day if no events happen

- Operation modes: Possibility to create state tables in the software, to define automatic changes of the operation modes, in the doors, during the day:
- Standard: the door is closed and a user with authorized access must approach its credential to open the door
- Double user: the door is closed and two users with authorized access must approach their credentials to open the door
- Standard or ADA users: possibility to define the operation time of the electromechanical clutch to open the door, from one to 15 seconds. Standard users will have the defined time. ADA users will have double time than the specified
- High traffic door option: for unlimited number of users in one door. Recording the last 1.000 events. Optional in the offline, update on card and wireless systems

## 3 Scalable system / Upgradable firmware

There is one firmware per system and RFID reading technology. Firmware can be easily change through the programming device.

## 4 Mobile solutions

### (Openow/Remote TESA SMARTair App)

The padlock must include from the factory one of the following RF modules:

- Openow module: for offline and update on card systems with Openow functionality
- Wireless + Openow module: for wireless system with Openow and/or remote TESA SMARTair App functionality

# Mechanic technical characteristics

The i-gate padlock is built by the assembling of one knob cylinder, the padlock and all together protected with a cover. The padlock includes the electromechanical clutch that will work together with the padlock. Allowing the opening of the padlock (or not) according to the instructions of the control unit.

## **i-gate padlock dimensions**

Double security locking mechanism. Stainless steel shackle.

To open the door the users will need to use their credential or mobile phone.

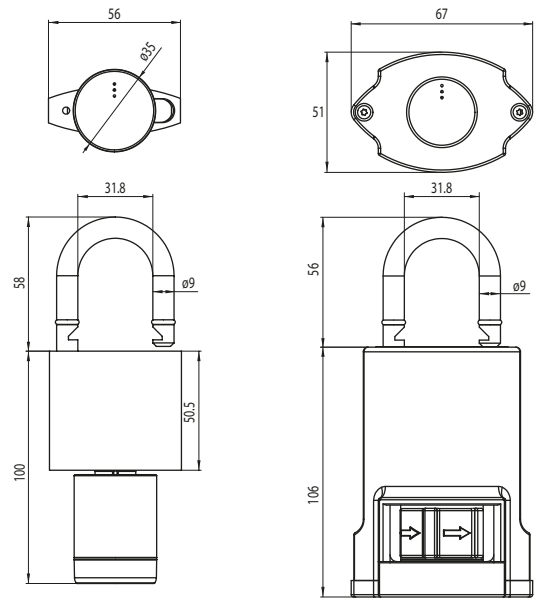

It is very important to push the shackle firmly when closing this will guarantee the padlock is correctly sealed

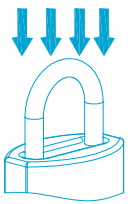

## **How to open a door with a SMARTair Padlock**

- Present your card/token to the reader of the padlock which is located at the bottom
- The blue LED of the reader will illuminate, open the padlock by turning within 4 seconds
- If you have a red LED it means you are not authorised to open it

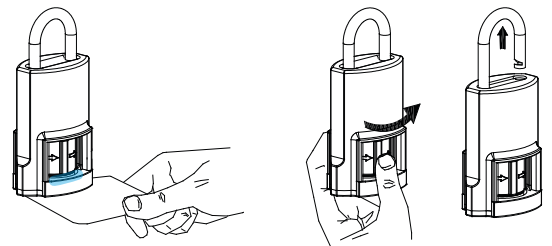

## **Important information for weatherproof version**

- Weatherproof protection of the padlock is guaranteed only if the padlock stands vertical keeping the shackle upwards
- Weatherproof protection of the padlock is guaranteed only while the shackle is closed. Do not leave the padlock open!

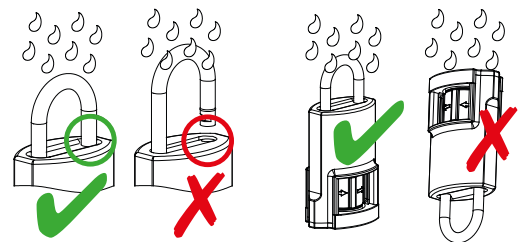

The i-gate padlock is offered with a black rubber finish.

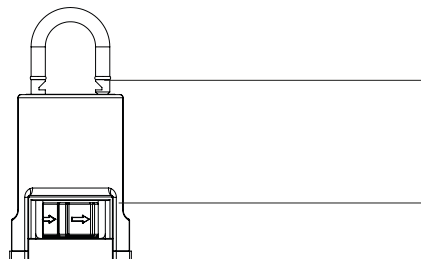

## **Finishes**

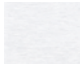
 Padlock shackle in stainless steel

Stainless steel

 Padlock cover in black finish

Black

The ASSA ABLOY Group is the global leader in access solutions. Every day, we help billions of people experience a more open world.

ASSA ABLOY Opening Solutions leads the development within door openings and products for access solutions in homes, businesses and institutions. Our offering includes doors, door and window hardware, locks, access control and service.

[assaabloyopeningsolutions.com](https://assaabloyopeningsolutions.com)

ASSA ABLOY Opening Solutions EMEA  
Digital and Access Solutions  
Dukes Court  
Dukes Street  
Woking  
GU21 5BH  
United Kingdom  
[campaigns.assaabloyopeningsolutions.eu/smartair](https://campaigns.assaabloyopeningsolutions.eu/smartair)