

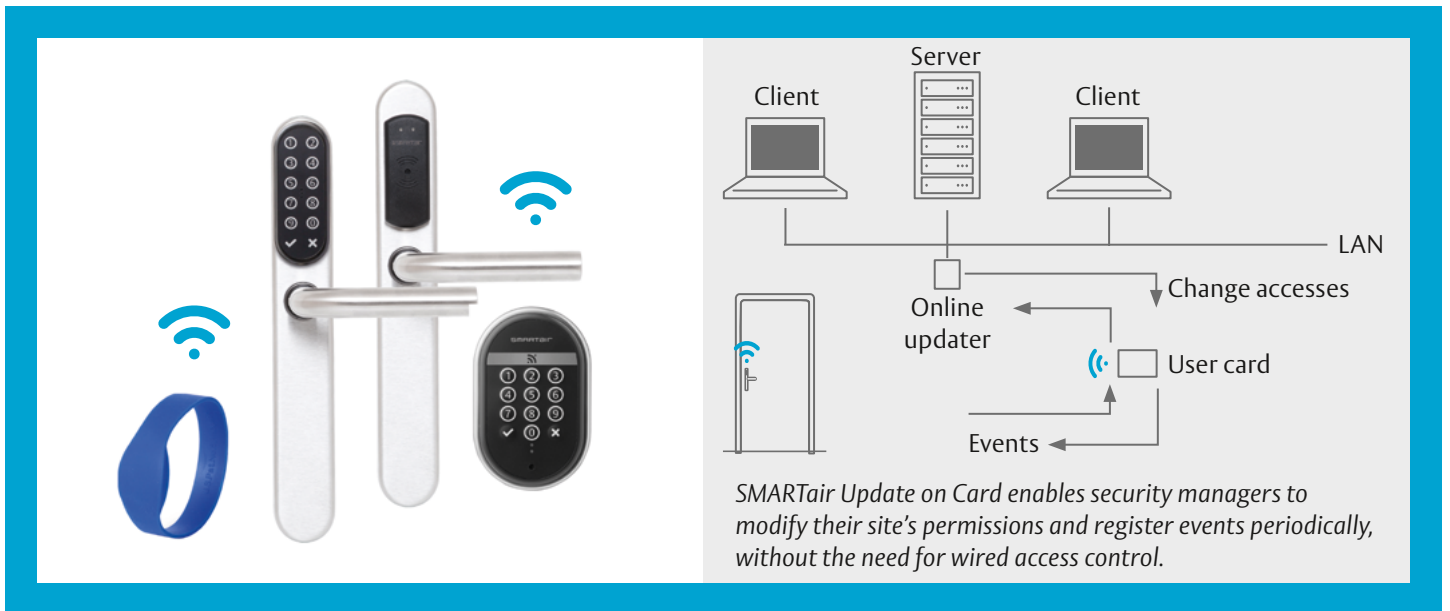

SMARTair® access control stops unauthorised entry to a mountain campsite

ASSA ABLOY
Opening Solutions

Experience a safer
and more open world



SMARTair Update on Card enables security managers to modify their site's permissions and register events periodically, without the need for wired access control.

While visitors enjoy the scenery, SMARTair takes care of security

“This is an ideal smart solution. Its simplicity, yet versatile functionality, makes it easy to manage.”

Savel Lubomir, Facility Manager at Tatra National Park



The SMARTair bracelet is the most convenient credential for such an adventurous environment

Project

Company: Tatra National Park (www.tanap.org)
Location: Tatra Mountains, Slovakia
Devices installed: SMARTair® Offline escutcheons & 350 wristband and Updater
ASSA ABLOY Brand: Mul-T-Lock
ASSA ABLOY partner: Rikeys
RFID technology: MIFARE®
Year of installation: 2016

Challenge

The Tatra National Park is a national symbol of Slovakia and in 1993 was designated a transboundary biosphere reserve by UNESCO. The park is famed for its mountainous scenery, and is visited by tourists, hikers and campers all year. On the Slovakian side of the border, park campground facilities were being used by day-trippers, when they were intended for registered campsite guests only. This increased the risk of theft and vandalism, as well as causing more wear and tear.

Key Requirements

- An access control solution to keep unauthorised users of the facilities out, yet also provide registered guests with secure access whenever needed
- Flexible management of access permissions, because campsite guests arrive and depart constantly
- Fast, easy cancellation of a credential's access rights, if one is lost or stolen
- Cost-effective retrofitting and day-to-day operation

Solution

Park management organisation TANAP turned to SMARTair to secure the designated campground facilities. They chose wireless access control, installing SMARTair battery-powered escutcheons; 350 wristband credentials were also supplied. Now, as guests check in, they receive a wristband which provides them with secure access to the facilities.

SMARTair has enabled TANAP to restrict access to registered users only. Authorisations for the wristbands are easily managed as visitors come and go, using simple and intuitive SMARTair admin software. If a visitor loses their wristband, or one is stolen, it's easy to program a new one that will cancel the lost credential.

The installation at the Tatra National Park campground runs via Update on Card, which is perfect for premises with medium to high user traffic. Now, campsite guests can access the facilities whenever they want, without needing to locate staff or wait around for someone to arrive with a key.

The result has been the instant elimination of unauthorised use at the campsite. *“SMARTair will also help us reduce damage and wear-and-tear on the facilities, which can directly impact costs and the use of our resources,”* adds Savel Lubomir.

Learn more:

campaigns.assaabloyopeningsolutions.eu/smartair