

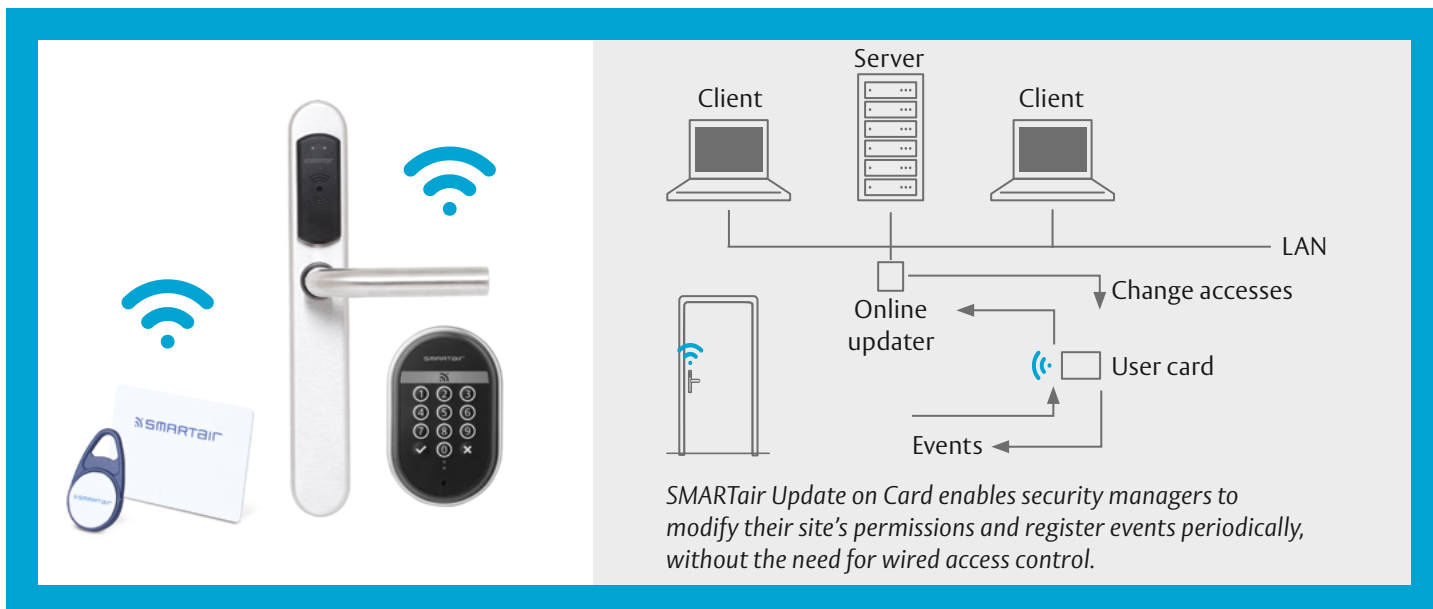

# CUNEF facilities managers take control with the SMARTair™ system

**ASSA ABLOY**  
Opening Solutions

Experience a safer  
and more open world



SMARTair Update on Card enables security managers to modify their site's permissions and register events periodically, without the need for wired access control.

## At Madrid's CUNEF, SMARTair upgrades security, flexibility and user-friendliness

*"We trusted the wireless SMARTair system because it's already used in other universities around the world, and the partner who installed the products was efficient and professional."*

Gregorio Pascual Carrascosa, Facility Manager, CUNEF

### Project

**Company:** Colegio Universitario de Estudios Financieros ([www.cunef.edu](http://www.cunef.edu)), more than 1600 students and 100 teachers

**Location:** Madrid, Spain

**Devices installed:** 250 SMARTair™ escutcheons, 6 updaters and wall readers

**ASSA ABLOY Brand:** TESA

**ASSA ABLOY partner:** Ferrreteria Ortiz

**RFID technology:** MIFARE™

**Year of installation:** 2014

### Challenge

The Colegio Universitario de Estudios Financieros, or CUNEF, is a prestigious Madrid university with a specialism in business administration, law, banking and finance. Students come from all over the world to study on CUNEF's Masters programmes.

As in many educational institutions, access control challenges at CUNEF centre around keeping the site secure while providing flexible and user-friendly access to an ever-changing roster of staff, students and visitors.

### Key Requirements

- avoiding a cumbersome, labour-intensive wired access control system
- giving administrators fine-grained control over door access, right down to the level of individual rooms such as private areas and teaching offices
- controlling student access to different areas of the university without needing to fit wired door locks
- an access control system that already has a track record in working with the complex needs of the education sector

- the ability to work with a trusted local partner who understands both the product and the specific requirements of CUNEF

### Solution

SMARTair is built for organizations making the step up from mechanical master key systems. Security at CUNEF needs to be watertight – no compromises – so the SMARTair Pro tailored solution was the number one choice. CUNEF selected 'Update on Card' management system, which allows cards to carry updated information to secured doors, adding flexibility for users and facilities managers. Local partner Ferrreteria Ortiz also installed 6 SMARTair updaters at CUNEF, so all users can update access rights easily. If a someone loses their card, there's no security threat. A manager can issue a new one that will cancel the lost card. SMARTair solves the problem of controlling multiple door types, which would not be possible with less advanced systems. SMARTair escutcheons have been fitted to secure glass doors and emergency exits. Installation was quick and easy, no wiring needed.

Because there's no wiring, CUNEF can extend access control to many more doors than would be feasible or affordable with a traditional wired system. With SMARTair, CUNEF facility managers can tailor access down to the level of each individual user or door.

Learn more:

[campaigns.assaabloyopeningsolutions.eu/smartair](http://campaigns.assaabloyopeningsolutions.eu/smartair)