

Aperio® L100 Wireless Lock

ASSA ABLOY
Opening Solutions

The cost-effective solution for doors
with demanding access control requirements

The ASSA ABLOY Aperio L100 is the most complete electronic wireless security lock on the market. It works with almost any system, via Online, Offline or OSS-standard offline integration.

Experience a safer
and more open world



Open with a smart card or mobile phone. The Keypad option offers multi-authentication for an extra layer of security.*

*Only supported by Aperio online

Main electronics inside – Reader element outside including emergency battery connector and indication LEDs.

Inside handle always engaged (request to exit sensor included).

Inbuilt LED instantly communicates if access is granted or denied.

Audio signal when card is presented or keypad is operated.

Integrated sensors for bolt, door position and mechanical key override.

Can be used with a wide range of handles.



Easy integration

Aperio L100 works seamlessly with access control systems integrated to Aperio via AADP protocol or Wiegand hub. No database integration required.



Highly effective burglary protection

Reader: IP54 outside part, IP44 inside part. Lock case: CE, EN 179, EN 14846 in progress.



Monitoring

Integrated sensors for door (open/closed); bolt position (locked/unlocked) and key mechanical override detection. Handle status detection (request to exit).



Convenience

Aperio L100 reads industry-leading RFID credentials, as well as mobile (NFC).

Versions:



Standard Reader



Keypad Reader



Reader escutcheon

Lock profile:



Standard



Narrow

Aperio® L100 FINNISH

Technical data and features

		
⌚	Authentication Code	CARD/Mobile, PIN, CARD/Mobile & PIN combined PIN code managed by the access control system
📶	RFID Technologies	iCLASS, iCLASS SE, iCLASS Seos, MIFARE Classic, Mifare Classic SE, Mifare Ultralight, Mifare Plus, Mifare DESFire 0.6, Mifare DESFire EV1, Mifare DESFire EV2, Mifare DESFire EV3 (EV2 and EV3 only in Legacy mode), Mifare DESFire SE, PicoPass, ISO 14443A UID, ISO 14443B UID, ISO 15693 UID
	RFID reading	UID / Sector / Block / Application / File / Data Depending on the RFID technology
	RFID Reading range	Up to 4 cm
🔄	Mobile Technology	NFC
✓	Approvals	CE, EN 179 and EN 14846 in progress
	Dimensions	Standard: Lock: 158 × 82 × 20 (H × W × D) Reader inside: 167,8 × 48 × 20 (H × W × D) Reader outside: 101,8 × 43,7 × 15 (H × W × D)
	Handle	Handle sold separately
	Surface	Reader: Plastic Reader Escutcheon: Stainless steel Faceplate for the lock: Stainless steel
⚙️	Door profile	Standard or narrow profile
	DIN direction	Left / right convertible
	Backset	Standard doors: 50 mm Narrow doors: 30 mm, 35 mm
	Distance	Standard doors: 69 mm Narrow doors: 115 mm, spindle 8 mm
	Spindle	See feature: Door leaf thickness
	Faceplate	22 mm
	Door leaf thickness	Spindle length – Door thickness in (): 47/50 (40- 54 mm); 57/50 (47/66 mm); 67/60 (61-80 mm); 74/50 (66-80 mm); 120/120 (88-100 mm); 80/50 (70-87 mm)
🔋	Battery	2 × Lithium AA (FR6)
	Battery life (Based on reader type)	65 openings per day for 50 months
	Emergency power	Via power supply connector
📡	Radio standard	IEEE 802.15.4 (2.4 GHz)
	Encryption (radio communication)	AES 128 bits
	Distance between the device and the hub	Up to 25m depending on the building environment
🌡️	Class of protection	IP 44 inside* / IP 54 outside**
	Operating temperature range	10°C to 65°C inside / -40°C to 65°C outside
	Relative humidity	< 85% (condensation-free)
	Status	LED (red/green/orange) Buzzer
💡	Door sensor information	Door position (open/closed); Bolt position (secured/unsecured); Mechanical key override (avoid alarm); Handle position (REX); Tamper detection
📶	Communication interfaces	Communication via radio (USB dongle) or Micro-USB cable (accessory)
	Offline and Online operation modes	Aperio Online; Aperio Offline; Standard OSS Offline
		* L100 is recommended for use indoors. However, it can be placed in a door facing outdoors (but the battery pack must be always in the indoor part). ** Harsh, outdoor environments may affect product operation (excessive humidity, salt, extreme temperatures).



It includes:

- 1 lock case with 2 batteries (Lithium AA FR6)
- Reader and main electronics
- Screws, flexible cables
- Spindles have to be ordered separately
- Manual including instructions for installation and drilling



Communicates with:

- RS485 Communication Hub
- Aperio IP Communication Hub
- Wiegand Interface (Standard and advanced versions) Communication Hub



Smart Credential Handling:

Up to 1000 users can be granted access even if the EAC is temporarily down.

Aperio® L100 Wireless Lock

L100 FINNISH

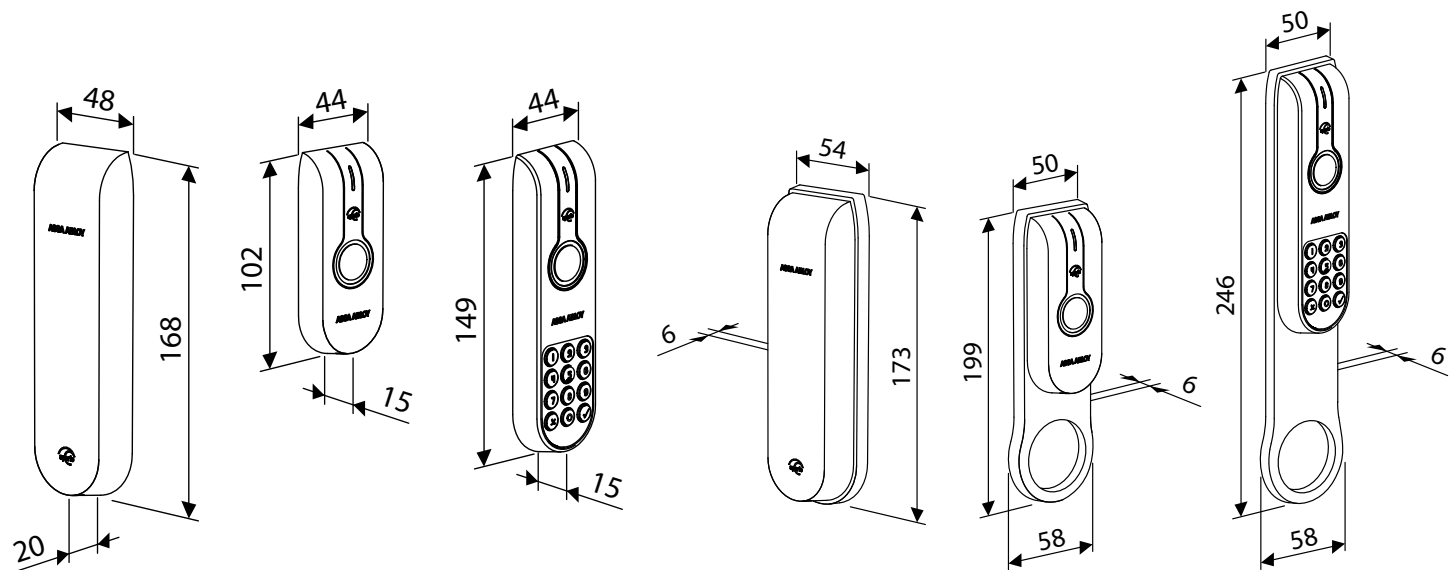
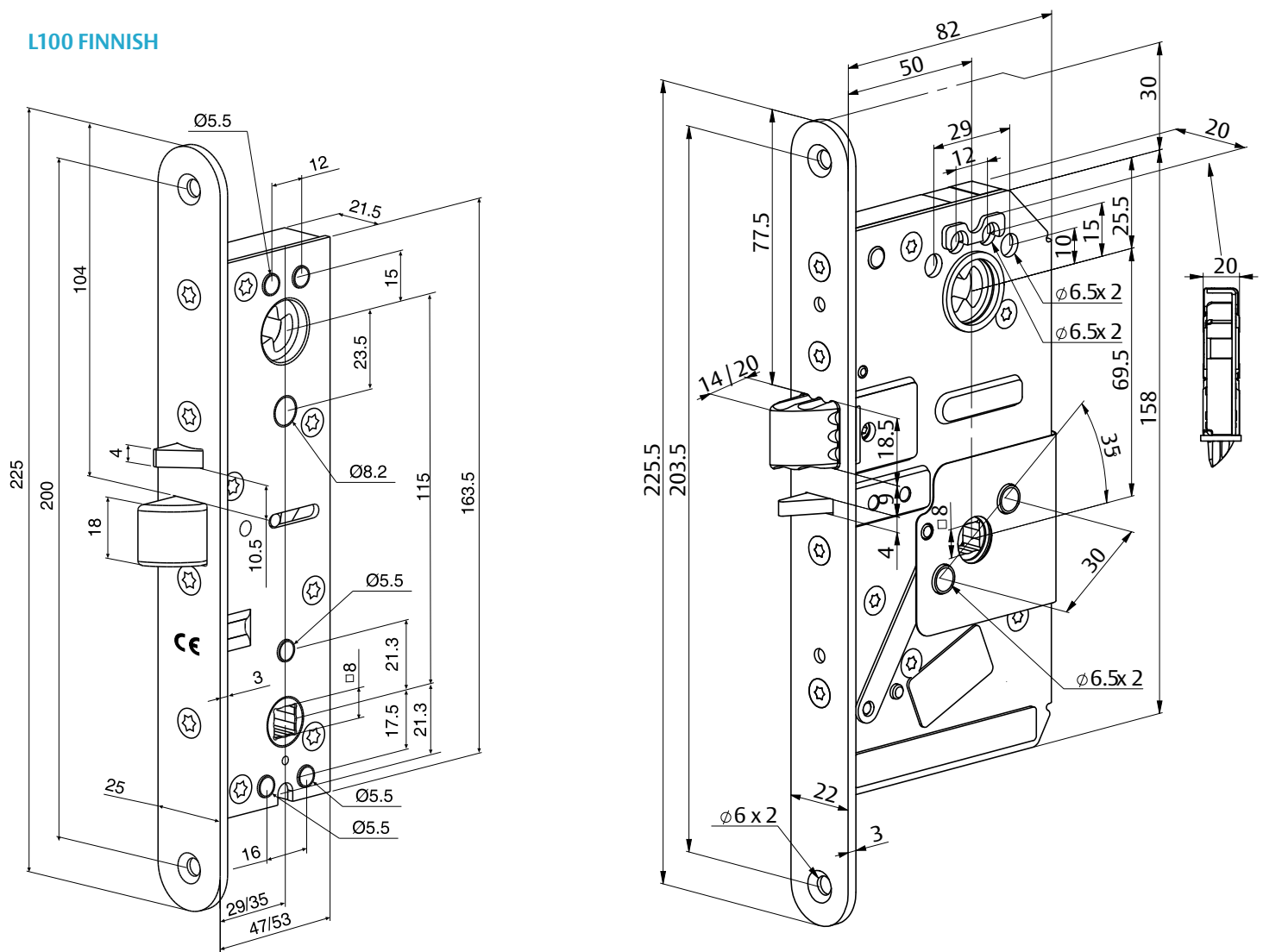

About ASSA ABLOY

The ASSA ABLOY Group is the global leader in access solutions. Every day, we help billions of people experience a more open world.

ASSA ABLOY Opening Solutions leads the development within door openings and products for access solutions and homes, businesses and institutions. Our offering includes doors, door and window hardware, locks, access control and services.

ASSA ABLOY

ASSA ABLOY Opening Solutions EMEA

Digital and Access Solutions
Dukes Court
Dukes Street
Woking GU21 5BH
United Kingdom

assaabloy.com 