



General Hardware

ASSA ABLOY

Experience a safer
and more open world

Features & Benefits

General Hardware

Key Features:

- Suitable for use in commercial and residential buildings
- A range of general door hardware suitable for most door applications

Benefits:

- Ease of door operations
- Aesthetics and functions
- Safety and security
- Protection of doors and walls

Products:

General hardware range

- Door Stops
- Coat / Robe Hooks
- Door Chains
- Bolts
- Door Viewer
- Barrel Bolts
- Timber and Aluminium Flush Bolts
- Sliding Door Hardware
- Push and Pull Plates

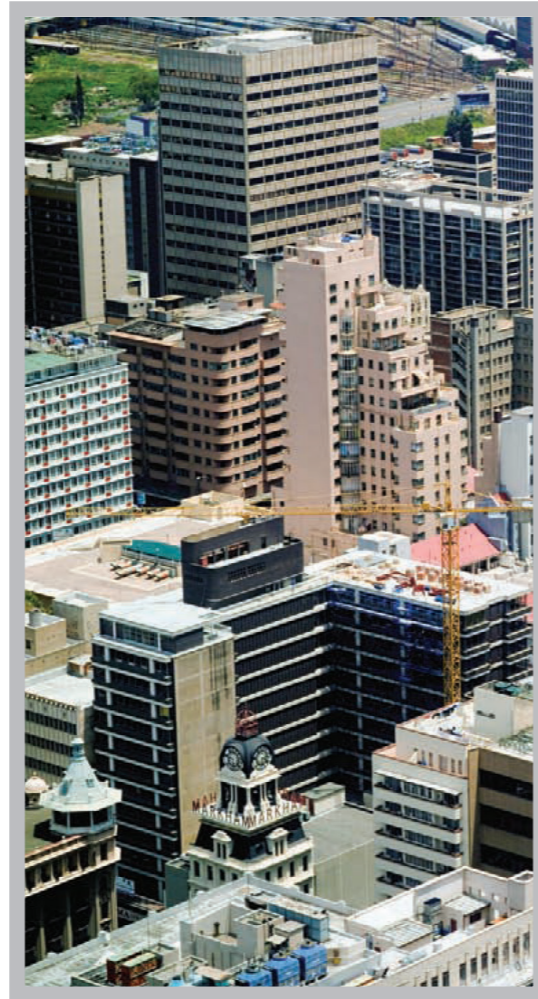

Rectangular Flush Pulls

Model no.: AFP-01, AFP-02

Dimensions: AFP-01 - 120mm x 50mm
AFP-02 - 150mm x 50mm

Finish: Satin Stainless Steel



Square Flush Pull

Model no.: AFP-03

Description: AFP-03 - 65mm x 65mm Square concealed Fix Flush
Dimension: 65mm x 65mm

Finish: Satin Stainless Steel



Circular Flush Pull

Model no.: AFP-04

Description: AFP-04 - 65mm diameter round concealed Fix Flush
Dimension: 65mm diameter

Finish: Satin Stainless Steel



Flush Ring Pull

Model no.: AFP-05

Dimension: 43mm x 63mm

Finish: Satin Stainless Steel



Conical Floor Door Stops

Model no.: AFS-03

Finish: Satin Stainless Steel



Dome Type Floor Stop

Model no.: AFS-01

Dimension: 45mmØ

Finish: Satin Stainless Steel



Tubular Wall Mount Stopper

Model no.: AWS-01

Dimensions: Ø 19mm x 63mm (H)

Finish: Satin Stainless Steel



Rod Type Floor Stop

Model no.: AFS-02

Description: Door Stop SSS
Dimension: 45mmØ

Finish: Satin Stainless Steel



Square Wall Mount Stopper

Model no.: AWS-02

Dimensions: 16mm x 16mm x 66mm

Finish: Satin Stainless Steel



Double Robe Hook

Model no.: ARH-01

Dimensions: Ø 51mm x 50mm (L)

Finish: Satin Stainless Steel



Coat / Robe Hook

Model no.: ARH-04

Dimensions: Ø51mm x 50mm (L)

Finish: Satin Stainless Steel



Double Robe Hook

Model no.: ARH-02

Dimensions: Ø 51mm x 50mm (L)

Finish: Satin Stainless Steel

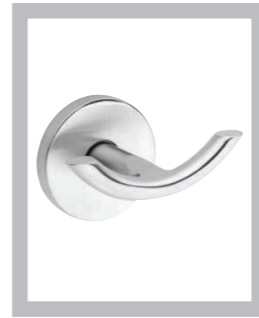

Coat / Robe Hook

Model no.: ARH-05

Dimensions: 20mm x 73mm (L)

Finish: Satin Stainless Steel

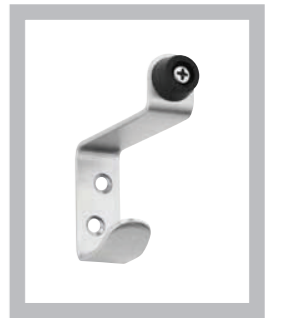

Double Robe Hook

Model no.: ARH-03

Dimensions: Ø 51mm x 50mm (L)

Finish: Satin Stainless Steel

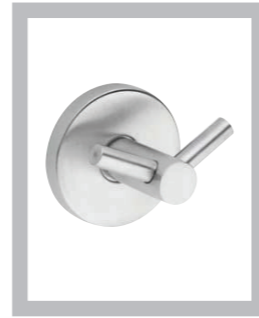

Concealed Security Chain

Model no.: ADSS-01

Dimensions: 25mm x 51mm x 100mm (min)

Finish: Satin Chrome





Model no.: ADSS-02
Finish: Satin Chrome

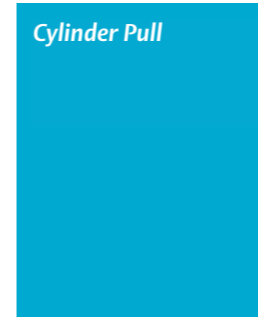
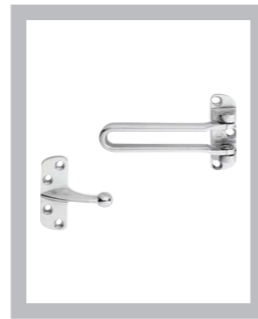

Model no.: ACP-01
Dimensions: 45mm x 76mm
Finish: Satin Chrome

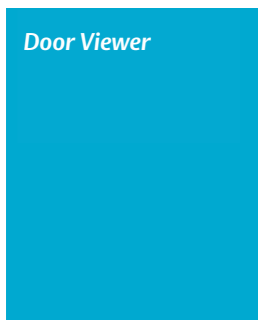

Model no.: ADSS-03
Description: Door thickness 40mm to 75mm
Finish: Satin Stainless Steel

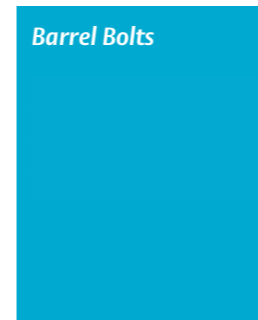

Model no.: ABB-01, ABB-02, ABB-03
Dimensions:
 ABB-01 - 100mm
 ABB-02 - 150mm
 ABB-03 - 200mm
Finish: Satin Stainless Steel

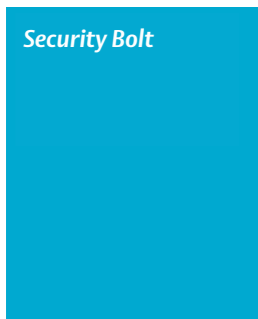
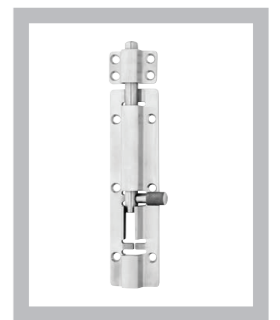

Model no.: ADSS-04
Dimension: 25mm x 51mm
Finish: Satin Chrome

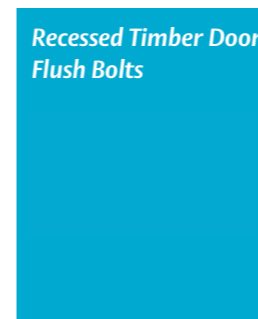

Model no.: ABT-01, ABT-02, ABT-03
Dimensions:
 ABT-01 - 200mm
 ABT-02 - 250mm
 ABT-03 - 400mm
Finish: Satin Stainless Steel



Extension Flush Bolt

Model no.: ABA-01, ABA-02, ABA-03

Dimensions:

ABA-01 - 200mm
ABA-02 - 450mm
ABA-03 - 600mm

Finish: Satin Stainless Steel



Dust Proof Strike

Model no.: AFBA-01

Dimensions: 39mm (H)

Finish: Satin Stainless Steel



Roller Bolts

Model no.: ABR-01

Dimensions: 22mm x 76mm x 45mm

Finish: Satin Chrome



1870 Series Cylinder Operated Flush Bolt

Designed for greater key control, the 1870 Cylinder Operated Flushbolt prevents accidental locking of the inactive leaf of narrow stile aluminum paired doors. May be installed to lock at threshold or at header.

Function

Designed for use instead of conventional flip-lever operated flushbolts, 1870 Cylinder-Operated Flushbolts give building management key control of the inactive leaf of paired narrow stile aluminum doors. Prevents casual locking of the inactive leaf by unauthorized persons. Uses same basic over-center action mechanism as MS® pivoted bolt deadlocks. Recommended for installation at both top and bottom of inactive door with MS1850S MS Deadlock in active door for greatest security. May be installed to lock at threshold or at header.

Operation

360° turn of key throws or retracts the hex-section bolt. Key can be removed only when bolt is in a positively locked or unlocked position. Lock accepts any standard 1" [25.4 mm] length, 1-5/32" [29.4 mm] diameter mortise cylinder with MS® cam such as the 4036 Mortise Cylinder, or thumbturn such as the 4066 Thumbturn, available separately. Lock accepts cylinder from either or both sides.



All measurements are approximate and are provided for informational purposes only. Refer to the product installation



Dimension

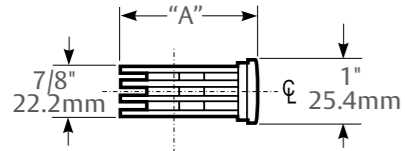

Stile Preparation

For installation locking threshold. Invert for header locking.

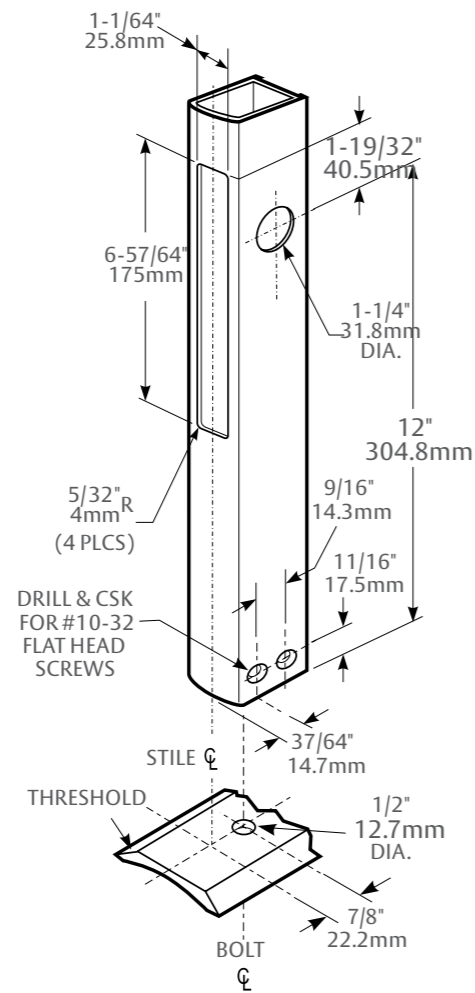
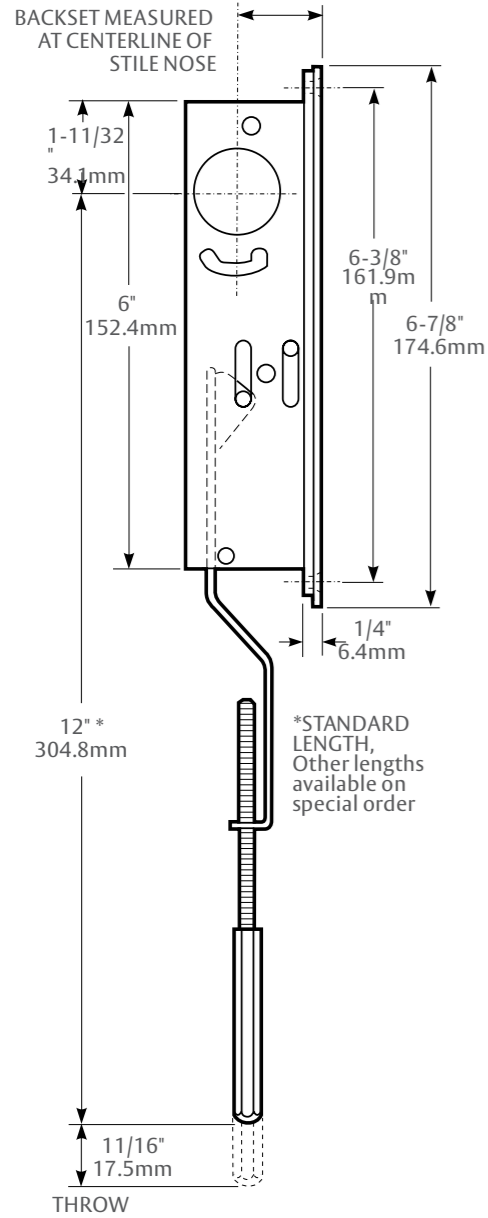

HOW BACKSET IS MEASURED:

CYLINDER \varnothing

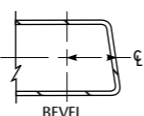
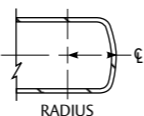
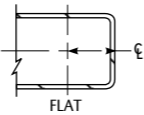

ARMORED FACEPLATE
1" X 6-7/8"

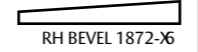
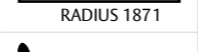
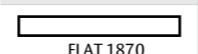

BACKSET	"A"
31/32" 24.6mm	1-5/8" 41.3mm
1-1/8" 28.6mm	1-25/32" 45.2mm

31/32" 24.6mm	1-5/8" 41.3mm
1-1/8" 28.6mm	1-25/32" 45.2mm

Toilet Indicator Bolt Set

Model no.: ABTI-01

Dimensions: 22mm x 77mm x 80mm

Finish: Satin Stainless Steel



Flush ring pull Latchset

Model no.: AFRPL-01

Dimensions: \varnothing 76mm x 12 turns

Finish: Satin Stainless Steel



Sliding Cavity Door Lock Furniture Cylinder escutcheon set

Model no.: ASLF-01

Dimensions: \varnothing 51mm

Finish: Satin Stainless Steel

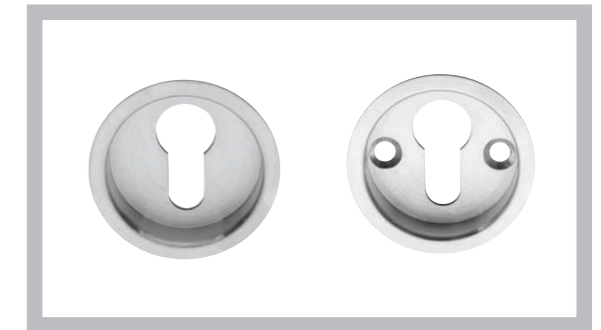

Sliding Cavity Door Lock Furniture Privacy set

Model no.: ASLF-02

Dimensions: \varnothing 51mm

Finish: Satin Stainless Steel



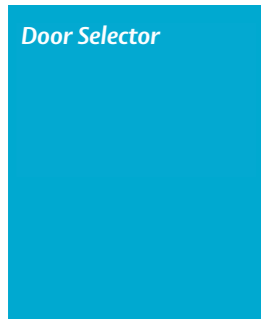

Model no.: AFDS-01
Dimensions: 280mm
Finish: Satin Stainless Steel



Model no.: AFFB-01
Dimensions: 31mm x 203mm
Finish: Satin Stainless Steel

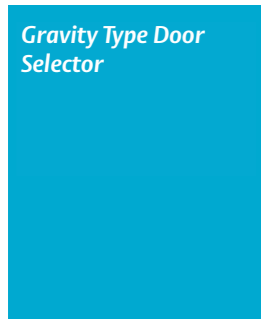

Model no.: AFDS-02
Finish: Satin Stainless Steel



Model no.: APP-3075, APP-3100
Dimensions: APP-3075 - 300mm x 75mm
 APP-3100 - 300mm x 100mm
Finish: Satin Stainless Steel

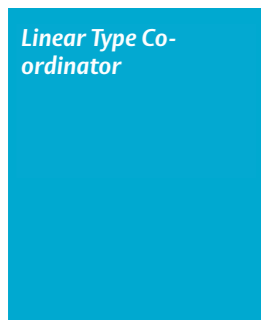

Model	Length	Door Width	Finish
AACSM32	32" (813mm)	1200-1500mm	Satin Stainless Steel
AACSM42	42" (1067mm)	1501-1800mm	Satin Stainless Steel
AACSM52	52" (1067mm)	1801-2200mm	Satin Stainless Steel
AACSM60	60" (1524mm)	2201-2600mm	Satin Stainless Steel



Model no.: APOP-3075, APOP-3100
Description: APOP-3075 ASSA ABLOY 300mm x 75mm Visible Fix Plate with 200mm x 19mm D Pull SSS
 APOP-3100 ASSA ABLOY 300mm x 100mm Visible Fix Plate with 200mm x 19mm D Pull SSS
Finish: Satin Stainless Steel



Square Rod Type Wall Mount Door Stop

Model No.: DSW-005

Dimensions: 16mm X 16mm X 66mm

Finish: Satin Stainless Steel

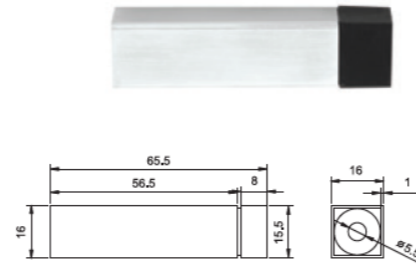

Staple Shape Magnetic Door Holder

Model No.: DOH001

Dimensions: 45mmØ X 74mm

Finish: Satin Stainless Steel



Rod Type Magnetic Door Holder

Model No.: DOH002

Dimensions: 50mmØ X 74mm

Finish: Satin Stainless Steel

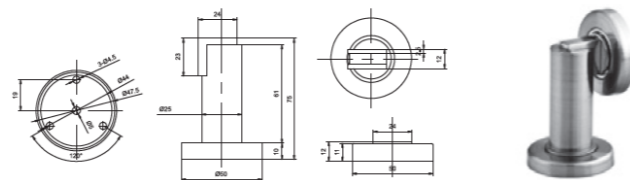

Concealed Magnetic Door Holder

Model No.: DOH003

Dimensions: 57mmØ X 48mm

Finish: Satin Stainless Steel

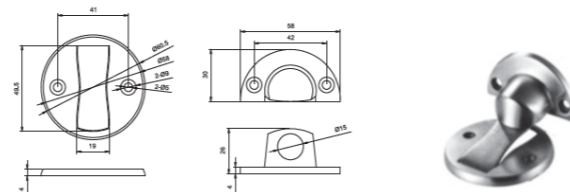

A4 Single Electromagnetic Lock

General Description

The Single Series Electromagnetic Lock should be constructed in an aluminium case with heavy duty electromagnet. The range only operates in Fail Safe mode and relies on a secondary lock or battery backup system. In some cases, the Magnet Armature Plate pivots to accommodate door drop. The lock needs to be equipped with "smart electronics" that have zero residual magnetism (instantaneous release). This is crucial for correct operation.

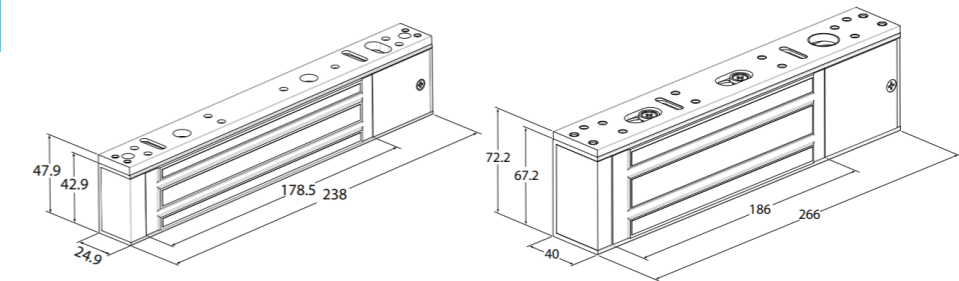

A4 Electromagnetic Lock

A8 Electromagnetic Lock

Typical Information

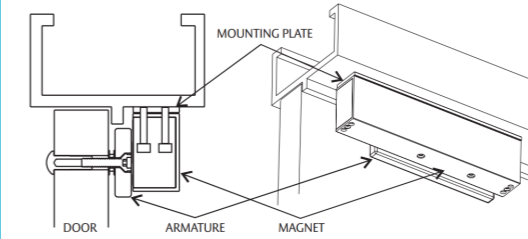

Ordering Information

Product Description	Part Number
Z4 Electromagnet - Non Monitored	770300-000T
Z8 Electromagnet - Non Monitored	770600-000T
Accessories	
Z2 L and Z Brackets	770150-901
Z4 L and Z Brackets	770300-901
Z 8 L and Z Brackets	770600-901
Z4 Glass Door Brackets	770300-905
Z8 Glass Door Brackets	770600-905
Z4 PC BOARD (NON-MONITORED)	770300-914

A4 Double Electromagnetic Lock

General Description

The Double Series Electromagnetic Locks operate with holding forces from 500kg up to 1160kg. Covering a range of applications these magnets are ideal for applications from access ways through to high use commercial swing doors. With fixing options including wood, aluminium and steel constructions, as well as glass door applications, the range caters to most electromagnetic needs.



Technical Details

	Non Monitored	Monitored
Holding force	500-560 Kg	550-560 Kg
Dimensions	(L)500 x (H)47 x (D)26mm	(L)500 x (H)47 x (D) 26mm
Voltage	12Vdc/24Vdc+/- 10%	12Vdc/24Vdc+/- 10%