



CY100: One key, many uses

ASSA ABLOY
Opening Solutions

Locking devices for more than just doors

Durable, high-performance locks and cylinders give confidence that your building is secure, inside and out. Robust, reversible keys save users time and stress. A single key can unlock a variety of different locking points.



Certified security
EN 1303:2015 Euro profile cylinders tested to 1 6 - B - C 5 D; including SKG** certification (for non anti-snap) plus rigorous in-house testing at ASSA ABLOY labs. Security technology patent protected until 2036.



Protection against cylinder attack
Secure anti-pick design with 15kN pulling resistance, 5 minutes' drilling resistance, bumping resistance (for keyed alike and keyed to differ), and optional anti-snap protection for additional security.



Precision engineered for durability
Durable design with 96-hour corrosion resistance and tested for 100,000 lock/unlock cycles.

Experience a safer
and more open world

CY100 Key



For all CY100
locking points



A single key unlocks every opening in your building. With its convenient dimple security design, the CY100 Key is reversible – it inserts and turns every time. Rounded edges protect against accidental damage. Patent protection prevents unauthorized duplication.



Reversible key design



Patent protection
prevents unauthorized
duplication

Technical data and features

Security	Patent-protected until 2036, Security card included
Keying	Dimple security design Keyed alike (KA) Keyed to differ (KD) Small master key system (MKS)
Number of keys	3
Max. number of key differs	39,411
Max. number of MKS profiles	4
Exclusive profiles	Customer specific profiles available
Profile shape	Paracentric
Raw material	Brass
Finish	Nickel
Key thickness	2.6 mm
Key neck length	15 mm
Weight	18 g

Dimensions in mm

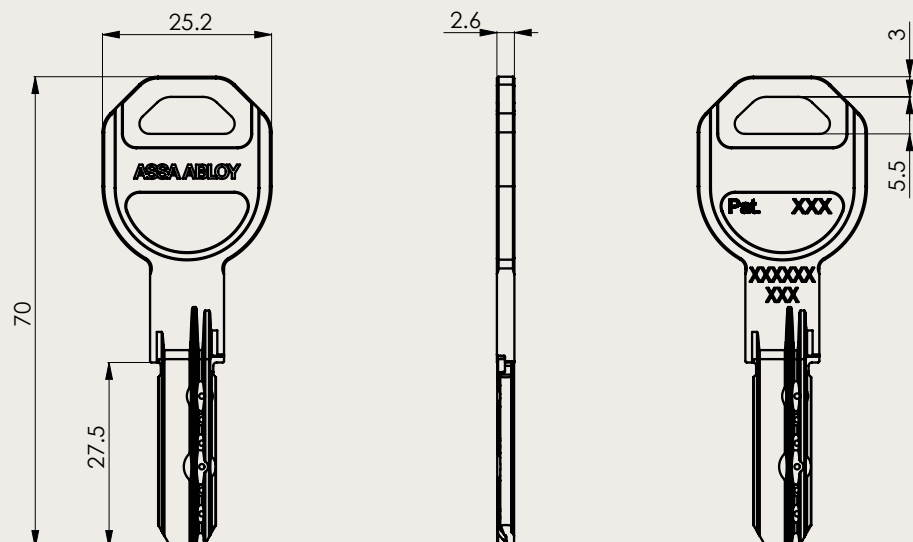

CY100 Double Euro Cylinder



For internal and external doors



Optional: Anti-snap cylinder

Durable and secure, the CY100 Double Euro Cylinder provides the protection you need to lock your building's doors – inside or out. Optional anti-snap protection offers additional security, keeping the cylinder's core protected when attacked.



Certified security



Protection against cylinder attack

Technical data and features

Security	SKG** certified (only for non anti-snap) EN 1303:2015 tested, 1 6 - B - C 5 D Cam DIN 18252 compliant
Attack resistance	Anti-pick Anti-drill: 5 minutes' drilling resistance Anti-pull: 15 kN pulling resistance Anti-bump (only for KA and KD) Anti-snap (optional)
Keying	Dimple security design Keyed alike (KA) Keyed to differ (KD) Small master key system (MKS)
Number of keys	3
Max. number of key differs	39,411
Max. number of MKS profiles	4
Number of pins	6
Raw material	Brass
Finish	Satin Nickel
Cylinder length	Minimum: 31 31 mm; Maximum: 76 76 mm; Increments: 5 mm
Weight	165 g
Optional functionality	Emergency clutch Free wheeling cam Gear wheel cam Construction keying

Dimensions in mm

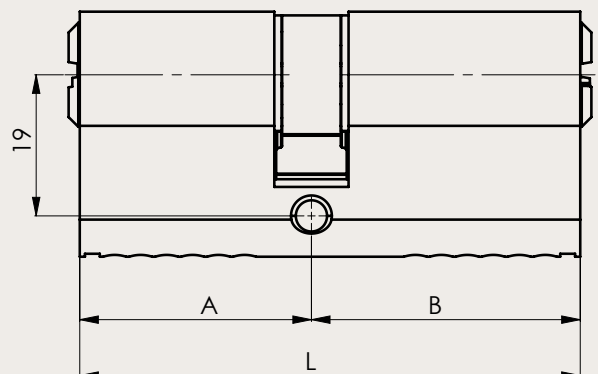
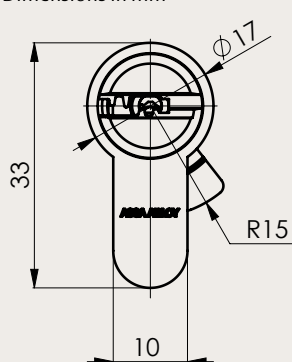

CY100 Thumbturn Double Euro Cylinder



For internal and
external doors



Optional: With coin slot

A secure solution when privacy is required: CY100 Thumbturn Cylinders securely lock doors and can quickly unlock to provide a faster exit. An optional coin slot ensures the lock can also be opened from outside in an emergency.



Certified security



Protection against
cylinder attack

Technical data and features

Security	SKG** certified (only for non anti-snap) EN 1303:2015 tested, 1 6 - B - C 5 D Cam DIN 18252 compliant
Attack resistance	Anti-pick Anti-drill: 5 minutes' drilling resistance Anti-pull: 15 kN pulling resistance Anti-bump (only for KA and KD) Anti-snap (optional)
Keying	Dimple security design Keyed alike (KA) Keyed to differ (KD) Small master key system (MKS)
Number of keys	3
Max. number of key differs	39,411
Max. number of MKS profiles	4
Number of pins	6
Raw material	Brass
Finish	Satin Nickel
Cylinder length	Minimum: 31 31 mm; Maximum: 76 76 mm; Increments: 5 mm
Thumbturn dimensions	31.5 x 17.5 x 39 mm (W x H x D)
Weight	280 g
Optional functionality	Gear wheel cam 70 mm spindle Emergency release coin slot Construction keying

Dimensions in mm

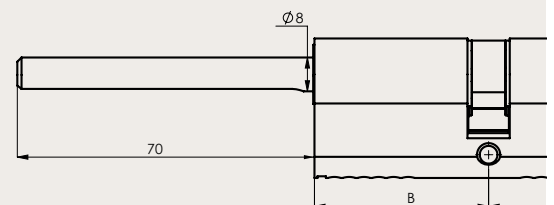
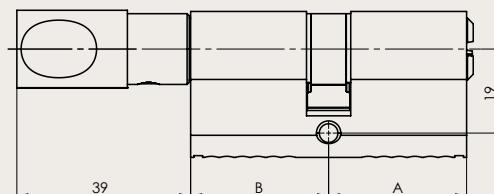
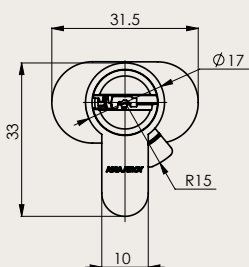

Optional: With 70 mm spindle replacing the thumbturn.

CY100 Single Euro Cylinder



For internal doors



Optional: Adjustable cam

Highly durable cylinder with the performance to secure your building. Keep your interior spaces secure with the CY100 Single Euro Cylinder. The optional multi-position cam allows to turn the cam into the application's required position.



Certified security



Protection against cylinder attack

Technical data and features

Security	SKG** certified (only for non anti-snap) EN 1303:2015 tested, 1 6 - B - C 5 D Cam DIN 18252 compliant
Attack resistance	Anti-pick Anti-drill: 5 minutes' drilling resistance Anti-pull: 15 kN pulling resistance Anti-bump (only for KA and KD) Anti-snap (optional)
Keying	Dimple security design Keyed alike (KA) Keyed to differ (KD) Small master key system (MKS)
Number of keys	3
Max. number of key differs	39,411
Max. number of MKS profiles	4
Number of pins	6
Raw material	Brass
Finish	Satin Nickel
Cylinder length	Minimum: 31 9 mm; Maximum: 71 9 mm; Increments: 5 mm
Weight	115 g
Optional functionality	Adjustable cam: 12 positions Gear wheel cam Construction keying Thumbturn variant

Dimensions in mm

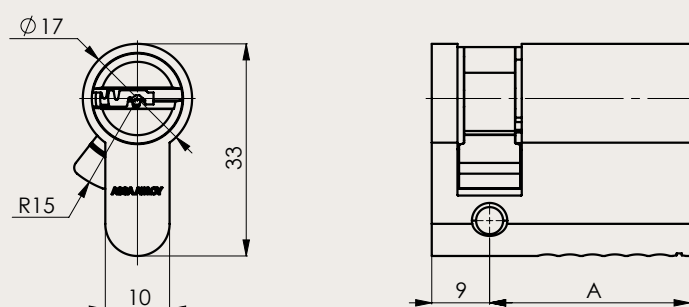

CY100 Rim Cylinder



Additional security
for external doors



Secure entrances while at the same time, enabling anyone inside to make an easy exit. The CY100 Rim Cylinder can be used with night latches or other locking devices which are operated from a tailbar.

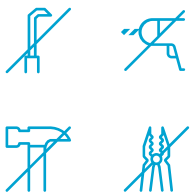

Protection against
cylinder attack

Technical data and features

Attack resistance	Anti-pick Anti-drill Anti-pull Anti-bump (only for KA and KD)
Keying	Dimple security design Keyed alike (KA) Keyed to differ (KD) Small master key system (MKS)
Number of keys	3
Max. number of key differs	39,411
Max. number of MKS profiles	4
Number of pins	6
Raw material	Brass
Finish	Satin Nickel
Dimensions	Face diameter: 32 mm Body diameter: 29 mm Tailbar length: 53 mm
Weight	175 g

Dimensions in mm

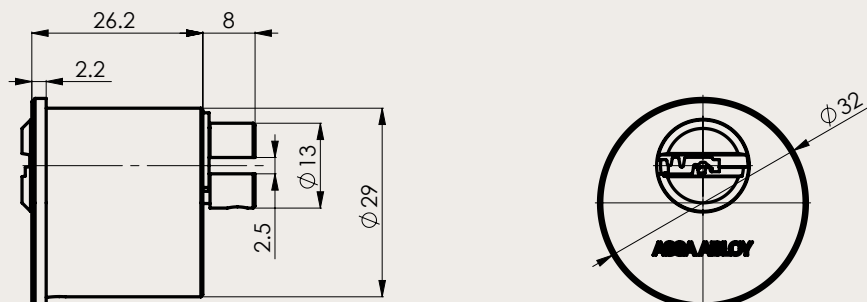

CY100 Cam Lock



For indoor and outdoor locking points



Keep sensitive documents and possessions safe. Secure and unlock your letterbox, cabinets and drawers with one single key. When in the unlocked position, the CY100 Cam Lock retains the key to prevent your possessions being left at risk.



Protection against cylinder attack

Technical data and features

Attack resistance	Anti-pick Anti-bump (only for KA and KD)
Keying	Dimple security design Keyed alike (KA) Keyed to differ (KD) Small master key system (MKS)
Number of keys	3
Max. number of key differs	39,411
Max. number of MKS profiles	4
Number of pins	6
Raw material	Brass
Finish	Satin Nickel
Dimensions	Face diameter: 24.8 mm Body diameter: 22 mm, laterally flattened to 17.5 mm Cam: Various designs
Weight	100 g

Dimensions in mm

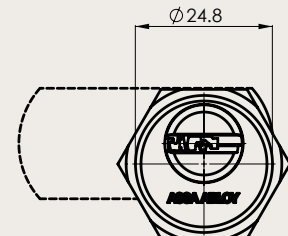
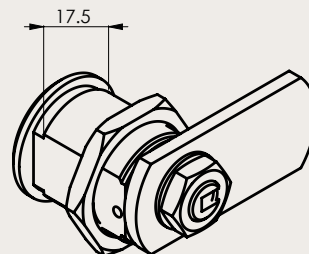
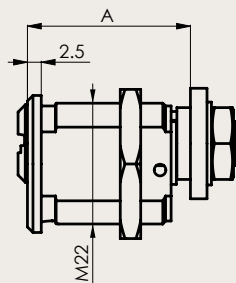

Various cam designs

CY100 Padlock



For indoor and outdoor locking points



A trusted, robust padlock for multiple applications. Secure almost anything with the CY100 Padlock, inside or outdoors. Suitable for sheds, gates, fences, lockers, storage boxes, bike chains, and more.



Certified security



Protection against cylinder attack

Technical data and features

Security	EN 12320:2012 tested – Grade 2
Attack resistance	Anti-pick Anti-bump (only for KA and KD)
Keying	Dimple security design Keyed alike (KA) Keyed to differ (KD) Small master key system (MKS)
Number of keys	3
Max. number of key differs	39,411
Max. number of MKS profiles	4
Number of pins	6
Raw material	Body: Brass Shackle: Stainless Steel
Finish	Satin Nickel
Body dimensions	Width: 52 mm Length: 45 mm Thickness: 20 mm
Shackle diameter	8 mm
Shackle clearance	30 mm, 100 mm
Weight	350 g (for 30 mm shackle clearance)

Dimensions in mm

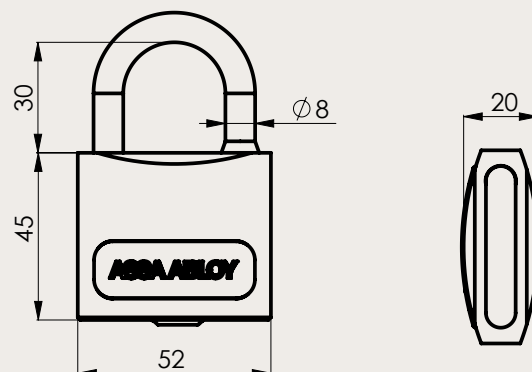

Glossary of optional CY100 functionality



An aid to better understanding



70 mm spindle

The cylinder is assembled with an axis instead of the thumbturn, so a customer can cut it to a preferred size to fit their own turn design. Mostly used for thicker door constructions like armoured doors.



Emergency release coin slot

Used in combination with a Thumbturn Cylinder – commonly in bedrooms or toilets – a coin slot allows emergency lock release from outside.



Anti-snap protection

The cylinder is designed to break under attack, while leaving the inner plug intact. If the lock is attacked, the cylinder breaks in a secure, pre-defined place. With the main mechanism intact, the keyholder can still use their key to unlock the door, so the cylinder doesn't need immediate replacement.

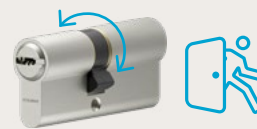

Free wheeling cam

The cam spins freely through 360 degrees and only engages when a key is inserted. When no key is inserted, none of the plugs operate with the cam. This feature is typically used with panic function, in emergency and panic exit doors (EN 179 and EN 1125).



Construction keying

One temporary key gives contractors access to several homes during building phase. Homeowner keys are protected from duplication when they move in. When inserted and turned, their key changes the cylinder's internal mechanism, permanently invalidating the construction key.



Gear wheel

Cylinders with a gear wheel instead of a cam are used in doors with horizontal lock bar, for example. These locks are designed to work with gear wheels, not a cam.



Multi-position cam

The cam can be adjusted to 12 different positions within a 30-degree angle by pressing the cam's locking pin and turning the cam into the application's required position. For use with key switches.



Emergency clutch

When a key is accidentally left in the keyway on one side, you can still operate the cylinder from the other.

The ASSA ABLOY Group is the global leader in access solutions. Every day, we help billions of people experience a more open world.

ASSA ABLOY
Opening Solutions

ASSA ABLOY Opening Solutions leads the development within door openings and products for access solutions in homes, business and institutions. Our offering includes doors, door and window hardware, locks, access control and service.

ASSA ABLOY Opening Solutions Middle East

UAE Office

P.O. Box 37765
Jabel Ali, Industrial Area 1
Dubai, United Arab Emirates
Tel: +971 4 880 4888
Fax: +971 4 880 4888

Qatar Office

P.O. Box 32522
D-Ring Road, Al Mataar
Al Qadeem District, Regus Business Centre
1st Floor, Office 109
Doha, Qatar
Tel: +974 4 442 31264/65/66

Saudi Arabia Office

P.O. Box 25960
Abdulaziz Main Road,
2nd Floor, Riyadh, Kingdom of
Saudi Arabia
Tel: +966 1141 62075

Egypt Office

P.O. Box 11341
4A, Shafik Ghorbal
St. Roxy Cairo, Egypt
Tel: +20 12234 75737
Fax: +20 2225 78481

✉ info.me.open@assaabloy.com
🌐 www.assaabloy.com