

Wall Programming Device

User Instructions and Installation

D001485445



User Instructions

! Attention!

Turning the key in the key slot can damage the device:

The key slot is rigid.

Only insert the key, do not turn it!

i Note!

Update time and date: The time and date in the key are automatically updated each time a programming job is carried out.

Programming the key

- 1 Insert the key into the key slot.
 - ⇒ The programming job starts automatically.
 - ⇒ The data is programmed to the key. The programming process can take several minutes depending on the amount of data. During this time, the three LEDs flash white.
 - ⇒ When the programming task has been successfully completed, two ascending acoustic signals sound, the three LEDs go out and the display ✓ lights up green.
- 2 Remove the key.

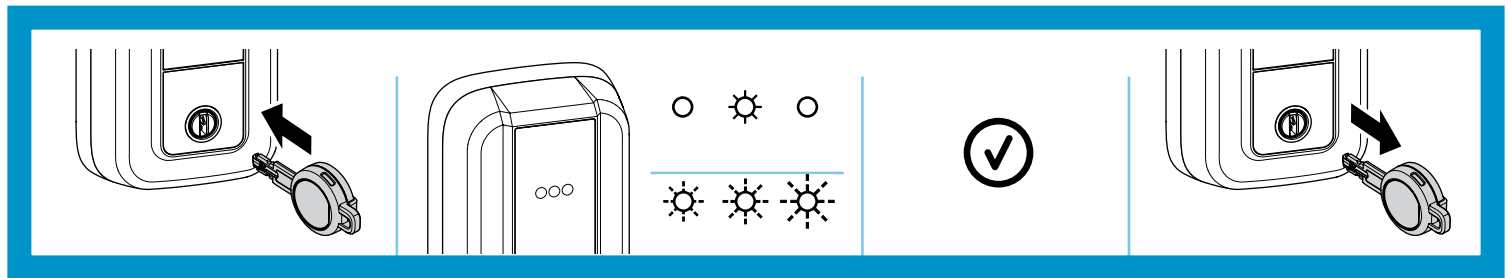

Indications

	green	Operation successful. This is also indicated by two increasing beeps.
	red	Operation failed. This is also indicated by two decreasing beeps. <i>Remove the key and reinsert after a few seconds.</i>
	yellow	The key battery is low. <i>Replace the battery in the near future.</i>
	red	The key battery is critically low. <i>Replace the battery immediately.</i>
	Middle LED lights up white	The device is connected and ready for use.
	Middle LED flashes white	The device has lost its connection with the CLIQ Remote server. Update without network connection only possible if "Offline update" is activated.
	All LEDs flash white one after the other	Operation running. Do not remove the key.
	Left LED flashes blue	Waiting for local area network connection.
	Middle LED flashes blue	Retrieving local area network configuration (DHCP).
	Right LED flashes blue	Establishing server connection.
	All LEDs flash blue	Updating firmware or settings.

Disposal



WEEE reg. no. DE 69404980

You must dispose of the product correctly as electronic scrap after use and take it to a local collection point for recycling free of charge.



Installation

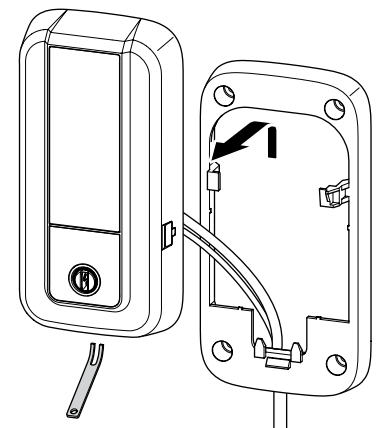
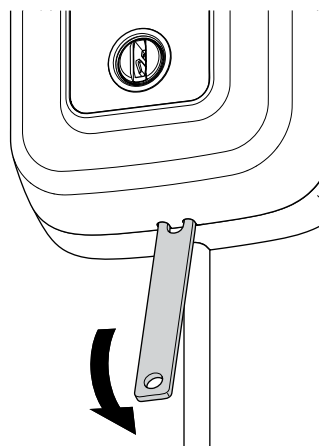
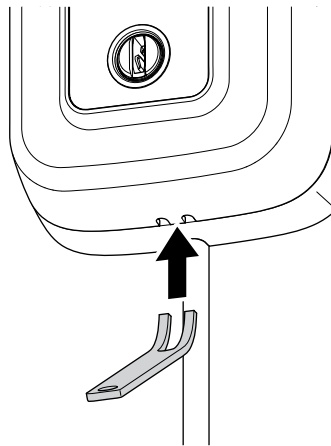
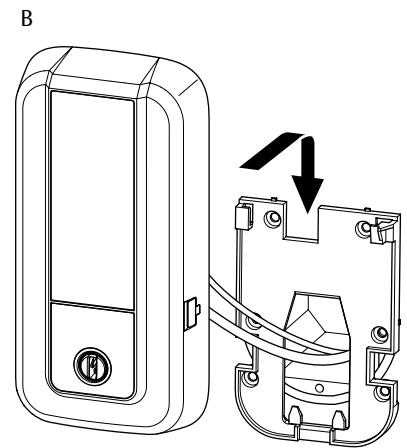
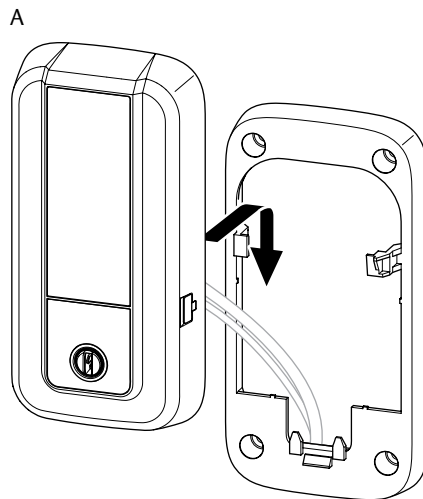
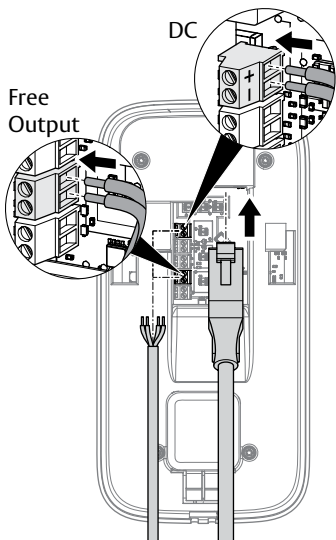
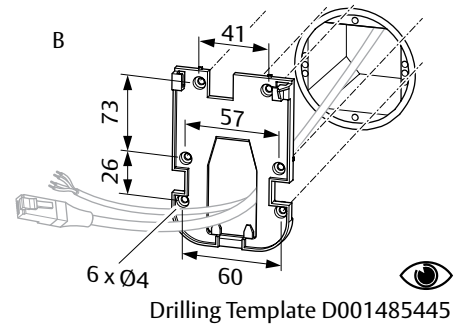
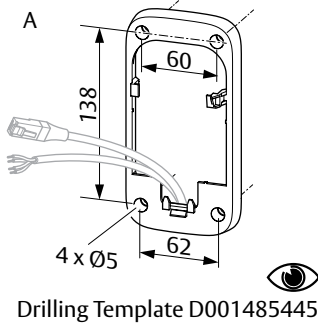
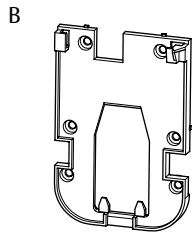
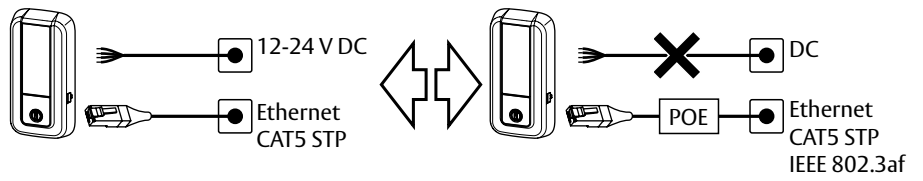
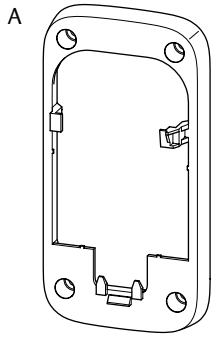

The ASSA ABLOY Group is the global leader in access solutions. Every day, we help billions of people experience a more open world.

ASSA ABLOY
Opening Solutions

ASSA ABLOY Opening Solutions leads the development within door openings and products for access solutions in homes, businesses and institutions. Our offering includes doors, door and window hardware, locks, access control and service.

ASSA ABLOY Opening Solutions

UAE Office

P.O. Box 37765
National Industrial Park (NIP)
Dubai, United Arab Emirates
Tel.: +971 (0) 4 880 4888

Qatar Office

P.O. Box 32522
D-Ring Road, Al Matar Al Qadeem District
Regus Business Centre, 1st Floor, Office 109
Doha, Qatar
Tel.: +974 44231264/65/66

Saudi Arabia Office

P.O. Box 25960
Abdulaziz main Road 2d floor
Riyadh, Kingdom Of Saudi Arabia
Tel. : +966114162075

Egypt Office

P.O. BOX 11341
4A, Shafik Ghorbal St. Roxy
Cairo, Egypt
Tel.: +20 1234 75737
Fax: +20 2225 78481



info.me.open@assaabloy.com



www.assaabloy.com